



## APP SETUP INSTRUCTIONS

### ABOUT THE POWER-POLE APP

While the Move can be used without the use of our Power-Pole App, connecting to the app unlocks a variety of useful features and allows for a perfectly tailored experience. Download the Power-Pole App from your device's App Store and follow the steps within the app to connect the Move.

### SELECT BOAT/ADD NEW BOAT

After successfully registering and/or logging in, create a **New Boat** profile and begin connecting to your accessories.

Tap the 3 horizontal lines  in the top left corner to access the side menu where options for **New Boat** or **My Boats** are available to select. For new installations, select **New Boat** and name it accordingly.

**NOTE:** The app will only allow connection/control of one Power-Pole Move Trolling Motor at a time. If two units are installed on the same boat, you must create a "Boat" for each unit.

Click the floppy disk  icon in the top right corner to save.

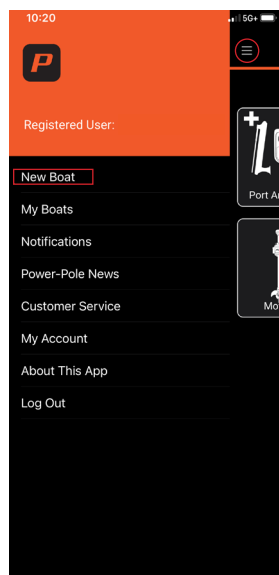

Create New Boat

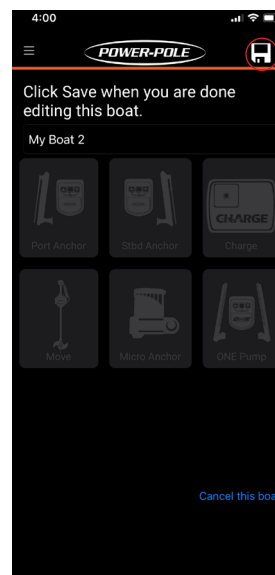

Save New Boat

Need help? Contact our Customer Service Team at **1 + 813.689.9932 Option 2**



## APP SETUP INSTRUCTIONS

### CONNECT TO THE MOVE

Ensure the Move you are trying to connect to is powered on, and select the **Move** from the **My Boat** screen. Select the Move you would like to pair to, and tap **Connect**. Follow on-screen prompts for security confirmation.

**NOTE:** Mobile device and remote must be within 3 feet of the unit when pairing.

Once connected, if there is an update available for the Move or any conneted accessories (remotes and displays), you will be prompted to update. If not prompted, it is recommended to check for new updates by selecting **Updates** from the drop down menu. **If an update is available, install the update before proceeding.**

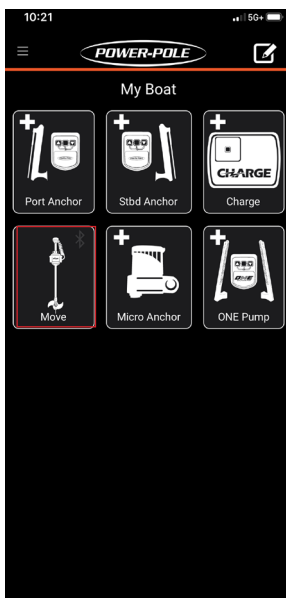

Select Move

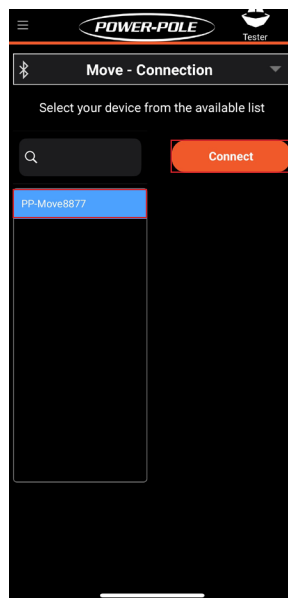

Connect Move

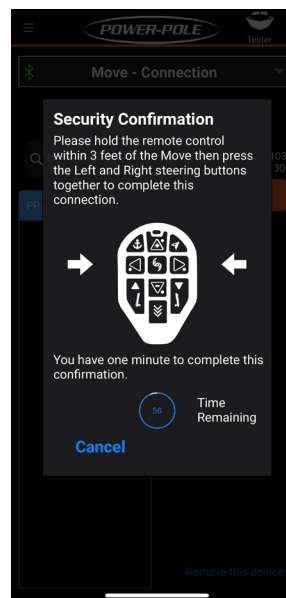

Security Confirmation

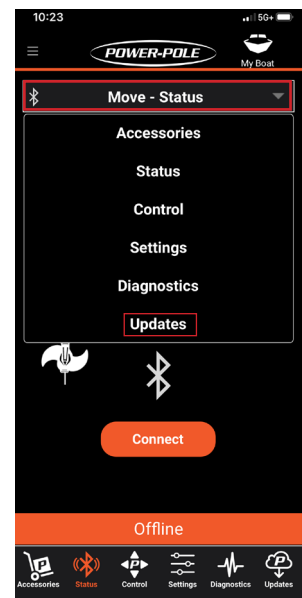

Check for Updates



## APP SETUP INSTRUCTIONS

### SET THE BOW ANGLE OFFSET

Next, set the bow angle offset to ensure your Move always points straight in line with your boat upon deployment. Navigate to the **Move - Settings** tab and tap the **Setup**  icon. Follow the in-app instructions to set the bow angle offset.

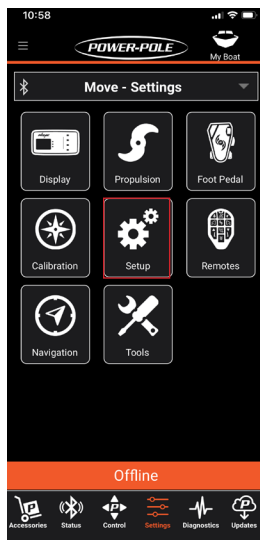

Tap Setup

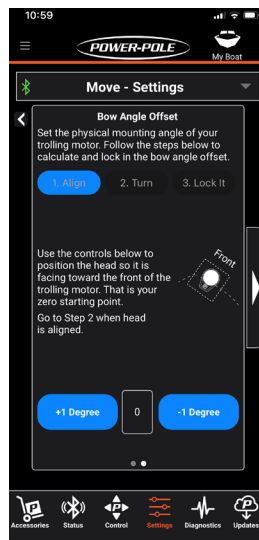

Align

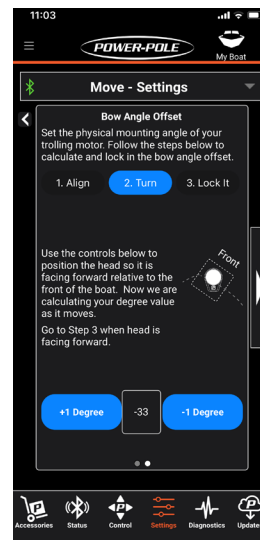

Turn

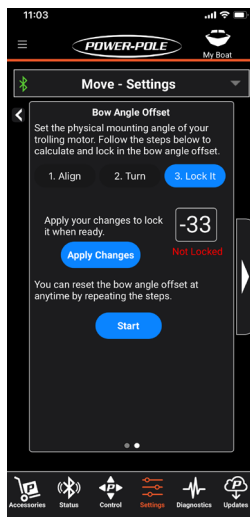

Lock

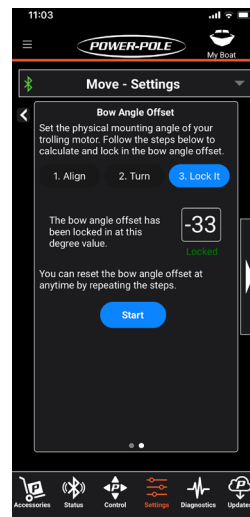

Locked

Need help? Contact our Customer Service Team at **1 + 813.689.9932 Option 2**



## APP SETUP INSTRUCTIONS

### CALIBRATE THE BASE CIRCUIT BOARD

All Move Trolling Motors are factory calibrated and ready for use. However, for best results, it is strongly recommended to perform a **Base Circuit Board** calibration before use.

#### Base Circuit Board Calibration

Navigate to the  **Move - Settings** tab and tap the **Calibration**  icon. Follow the in-app instructions to calibrate.

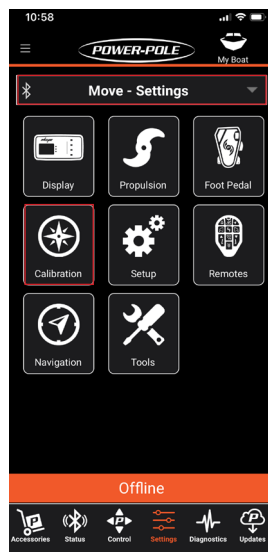

Tap Calibration

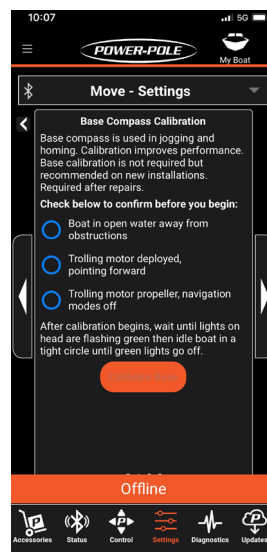

Follow Instructions



## APP SETUP INSTRUCTIONS

### CALIBRATION TEST

The Calibration Test is only required when a Customer Service Representative has requested data for analyzing an issue. It is also accessible from the **calibration** menu.

### ADDITIONAL CALIBRATIONS

The Head Compass and Steering Motor calibrations are not needed when setting up the Move. They are only necessary if the the steering or navigation head boards have been replaced. They are also accessible form the **calibration** menu.

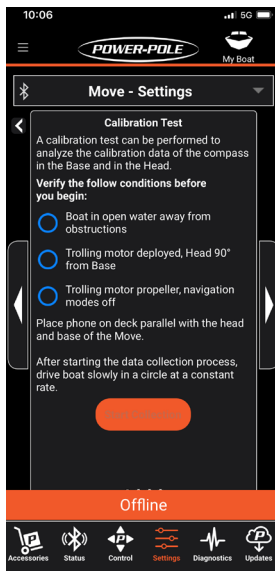

Calibration Test

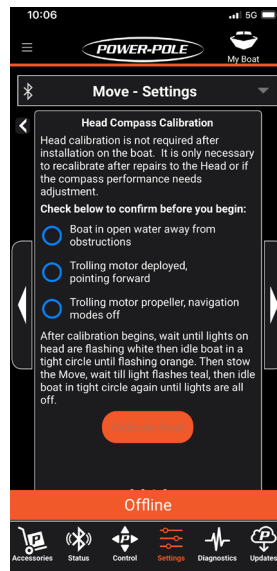

Head Compass Calibration

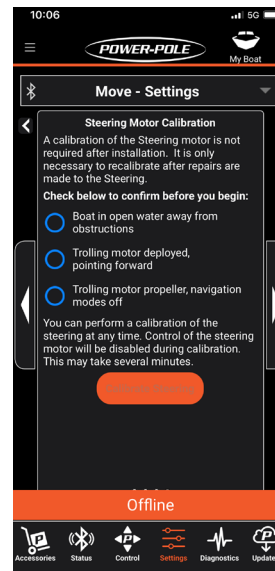

Steering Motor Calibration