



REAL-FEEL™ FOOT PEDAL INSTRUCTIONS

TOOLS

- Fine-tip Marker
- Electric Drill
- 9/64" Drill Bit
- Phillips Head Bit

INCLUDED HARDWARE

| LABEL | ITEM # | DESCRIPTION | QTY. |
|-------|----------------|--|------|
| A | SA-0032 | Foot Pedal Assembly | 1 |
| B | AVG-MP-0915 | 1/4" Thick Rubber Bushing | 4 |
| C | AVG-MH-WS-0283 | Small Stainless Washer | 4 |
| D | AVG-MH-SC-0278 | #10 x 1 1/4" Panhead Sheet Metal Screw | 4 |
| E | AVG-MP-1003 | Heat Shrink Butt Connector, 14-16 AWG | 1 |
| F | AVG-MP-1011 | Heat Shrink Ring Terminal, 14-16 AWG #10 | 2 |
| G | AVG-MP-1012 | Heat Shrink Ring Terminal, 14-16 AWG, 3/8" | 2 |
| H | AVG-MP-0934 | Fuse Holder, ATC, and ATO, 14 AWG, Red Leads | 1 |
| I | magnet-bot-PP | Pairing Magnet | 1 |

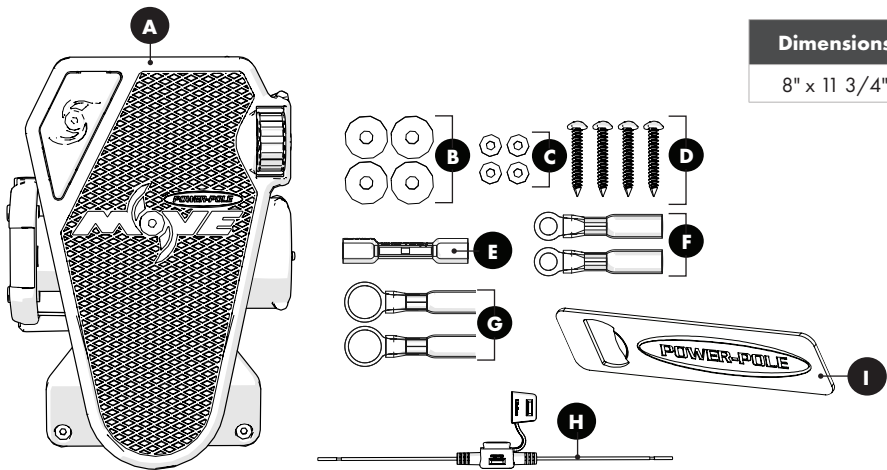

| Dimensions | Cord Length | Wire Gage | Fuse Size |
|--------------|-------------|-----------|------------|
| 8" x 11 3/4" | ~5' | 14 AWG | 3 Amp Mini |



Check the area beneath where the Foot Pedal will be mounted to ensure there are no hoses, wires, lines, tanks, or other sensitive components.

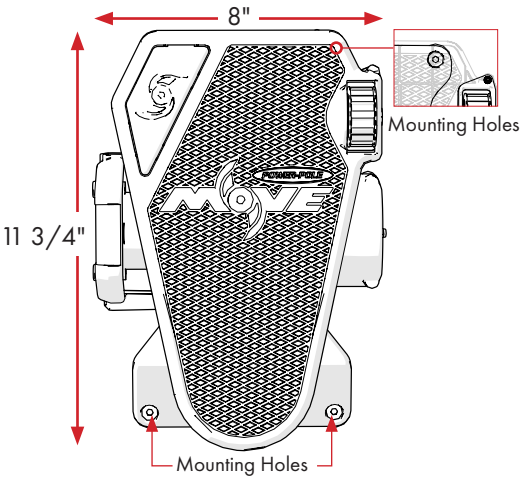

DRILL MOUNTING HOLES

- STEP 1** Choose a flat surface with adequate space to mount the **Foot Pedal** **A**.
- STEP 2** Using the included mounting template, mark and drill (4) pilot holes for **Mounting Screws** **D** using a **9/64" Drill Bit**.

IMPORTANT! If installing to gel-coat, follow the drilling procedure in **Appendix A** of the Installation & Owner's Guide to ensure you do not crack or chip the gel-coat.



REAL-FEEL™ FOOT PEDAL INSTRUCTIONS

INSTALL MOUNTING HARDWARE

Using a **#2 Phillips Head Bit** and **Electric Drill**, install mounting hardware in order and tighten snug.

1. (4) **#10 x 1 1/4" Panhead Screws** **D**
2. (4) **Washers** **C**
3. **Foot Pedal Assembly** **A**
4. (4) **Rubber Bushings** **B** (if needed)

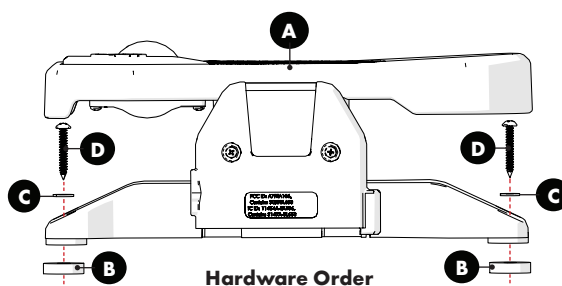

NOTICE: Rubber Bushings **B** are only required on curved boat decks.

CONNECT TO POWER

NOTICE: Follow **Appendix B** of the Installation & Owner's Guide for proper ring terminal and butt connector installation procedures.

STEP 1 Route wire to power.

STEP 2 Attach the **Fuse Holder** **H** to the **positive (+)** lead from the **Foot Pedal** **A** using **Butt Connector** **E**.

STEP 3 Depending on post size, attach the appropriate **Ring Terminal** **F** or **G** and connect to power, connecting the **positive (+)** lead to the positive post and negative (-) lead to the negative post.

NOTICE: All Move accessories are compatible with 12v, 24v, and 36v systems.

PAIRING PROCEDURE

Wave a **Magnet** **I** over the circuit board cover (see diagram). **This will open a 10 second pairing window.** During this time, the Foot Pedal will beep steadily. Finally, tap the **⏪** and **⏩** on the Move Remote at the same time, opening the pairing window on the Move. The Foot Pedal will chime, indicating it is now paired.

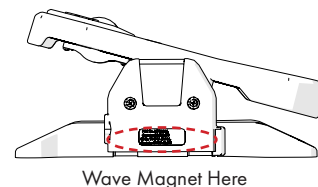

NOTICE: To open the pairing window, the Hybrid Remote must be within 2ft. of Base Circuit Board.

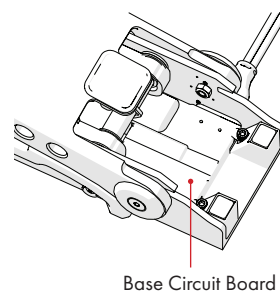

Need help? Contact our Technical Support Team at **1 + 813.689.9932 Option 2**



REAL-FEEL™ FOOT PEDAL INSTRUCTIONS

REAL-FEEL™ FOOT PEDAL TERMINOLOGY

The Foot Pedal is used for controlling the direction of the trolling motor, speed of the trolling motor, and for propeller operation. Use the information below to familiarize yourself with the layout, features and functions of the Foot Pedal.

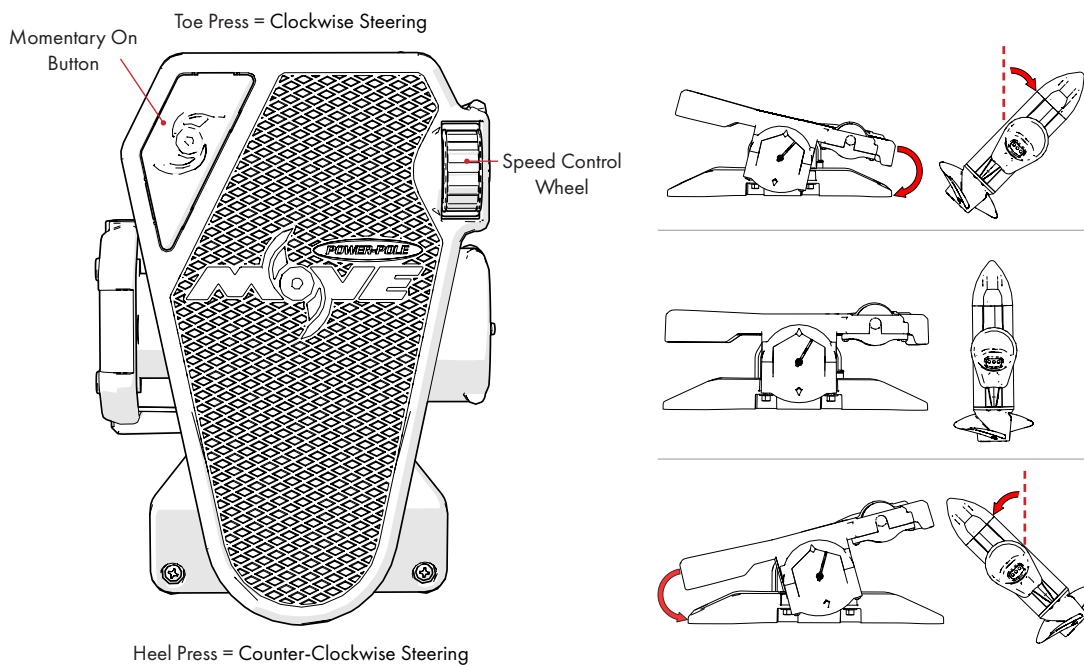

MOMENTARY ON BUTTON

Pressing and holding the **Momentary On Button** will turn the propeller on. The propeller will continue to operate while the button is being held down. When the button is released, the propeller will stop operating.

SPEED CONTROL WHEEL

The **Speed Control Wheel** determines the speed at which the propeller spins. Turning the **Speed Control Wheel** clockwise (forward) will increase speed. Turning the **Speed Control Wheel** counter-clockwise (backward) will decrease speed. The Foot Pedal will make a single beep each time the speed is increased or decreased. The speed will be shown on the Info Display.