



SWIFT. SILENT. SECURE.

SPORTSMAN II LOWER U-CHANNEL REPLACEMENT INSTRUCTIONS

- All models 2017 & Later

Installation Tools:

- 9/16" Wrench
- 9/16" Socket
- 1/2" Wrench
- 1/2" Socket
- Ratchet

NOTICE: No mounting hardware is included in this kit.



DO NOT touch the spike with bare hands.

REMOVAL & INSTALLATION:

STEP 1 Lower the Power-Pole Anchor® down so the Everflex™ spike is about a foot off the ground.

STEP 2 Follow diagrams (see reverse) to remove all hardware that attaches the U-Channel you are replacing (Upper or Lower).

STEP 3 Install the new U-channel by following the diagrams (see reverse).

IMPORTANT! Replace any hardware that is worn or damaged. Always replace nylon lock nuts. To order proper hardware, scan QR Code A.



QR Code A

Hardware Kit

Need help? Contact our Customer Service Team at **1 + 813.689.9932 Option 2**

SPORTSMAN II LOWER U-CHANNEL REPLACEMENT INSTRUCTIONS

- All models 2017 & Later

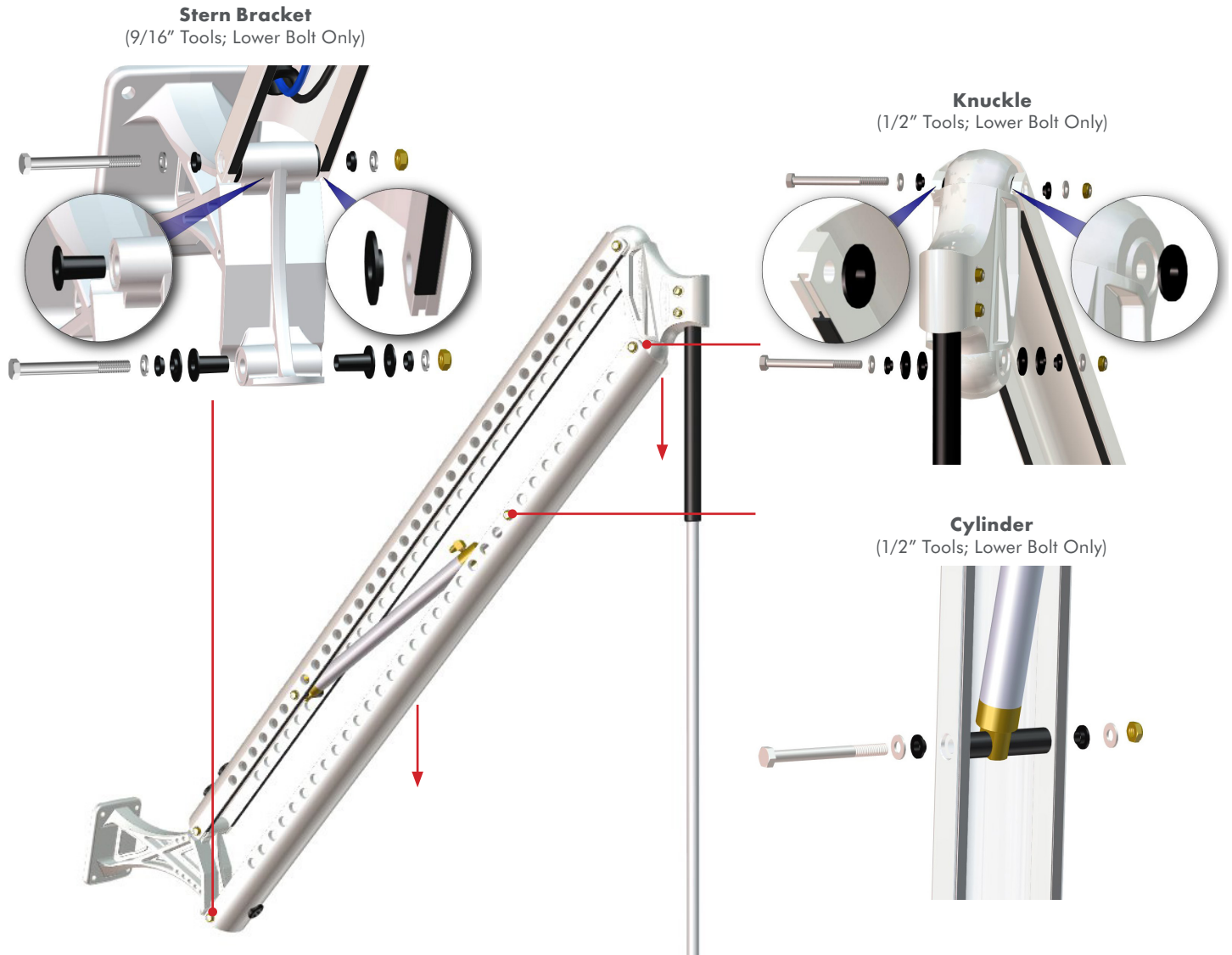

Need help? Contact our Customer Service Team at **1 + 813.689.9932 Option 2**