



SWIFT. SILENT. SECURE.

SPORTSMAN II UPPER U-CHANNEL REPLACEMENT INSTRUCTIONS

- All models 2017 & Later

Installation Tools:

- 9/16" Wrench
- 9/16" Socket
- 5/8" wrench
- 1/2" Wrench
- 1/2" Socket
- Ratchet
- Zip Ties (x2)
- Masking Tape

NOTICE: No mounting hardware is included in this kit.

IMPORTANT! Replace any hardware item that is worn or damaged. Always replace nylon lock nuts with new. To order a new **Hardware Kit**, scan **QR CODE A**.



DO NOT touch the spike with bare hands.

PRESSURE RELIEF:

STEP 1 Lower the Power-Pole Anchor® down so the Everflex™ spike is about a foot off the ground.

STEP 2 Manually push the anchor into closed position, relieving pressure.
Manually lower the anchor back to the ground.

REMOVAL:

STEP 1 Loosen the **UP Hose** from the **Lower Cylinder Fitting** using a **5/8" Wrench**.
Cover the hose end with masking tape. **FIG 1**

STEP 2 Remove the Hardware that attaches the **Upper Cylinder Fitting** to the U-Channel using a 1/2" Socket and wrench **FIG 2**.

STEP 3 Loosen the **DOWN Hose** from the **Upper Cylinder Fitting** by holding the fitting base with a **1/2" Wrench** and loosening the hose fitting with a **5/8" Wrench**.

FIG 3

IMPORTANT! Cover Hose ends with masking tape to prevent contaminants from entering.



QR Code A
Hardware Kit

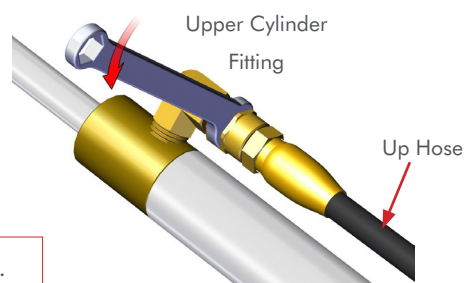

Figure 1

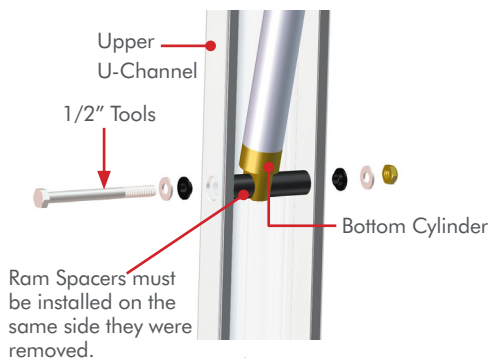

Figure 2

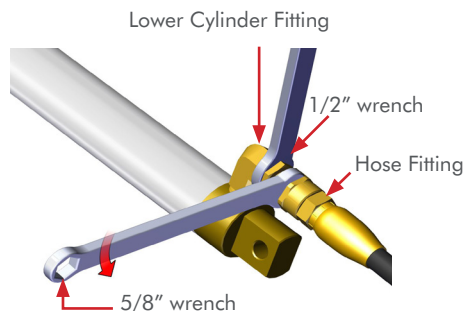

Figure 3

Need help? Contact our Customer Service Team at **1 + 813.689.9932 Option 2**

SPORTSMAN II UPPER U-CHANNEL REPLACEMENT INSTRUCTIONS

- All models 2017 & Later

STEP 4 Cut both **Zip-Ties**. **FIG 8**

STEP 5 Remove the **UP and DOWN Hoses** from the Power-Pole Anchor by pulling them through the U-Channel.

STEP 6 Follow diagrams (see page 3) to remove all hardware that attaches the defective U-Channel.

INSTALLATION:

STEP 1 Follow the diagrams on page 3 to install the new U-Channel.

STEP 2 Route the **UP Hose** through the Top Hole in the new U-Channel and the **DOWN Hose** through the Bottom Hole in the new U-Channel. **FIG 5**

STEP 3 Pull the **UP Hose** to the **UP Cylinder Fitting** and finger tighten.

STEP 4 While holding the **UP Cylinder Fitting Base** with a **1/2" Wrench**, turn the **UP Hose Fitting** clockwise a quarter turn with a **5/8" Wrench**. **FIG 6**

STEP 5 Repeat **Steps 3-4** for the **DOWN Hose**. **FIG 7**

STEP 6 Secure the **UP & DOWN Hydraulic Hoses** together about 4" to 5" from the bottom of **Hydraulic Cylinder** and around 4" to 5" up the cylinder using **Zip-Ties**. **FIG 8**

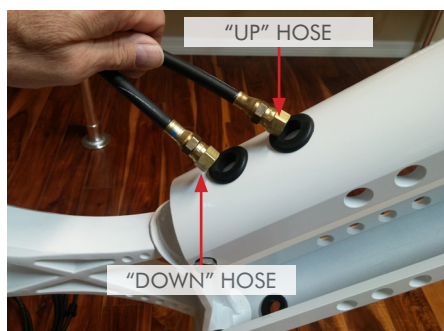

Figure 5

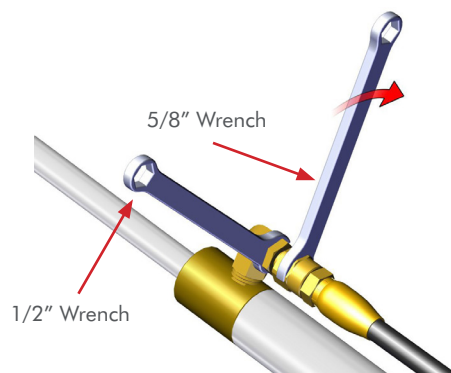

Figure 6

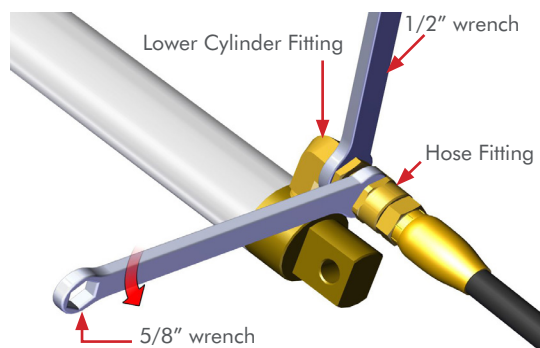

Figure 7

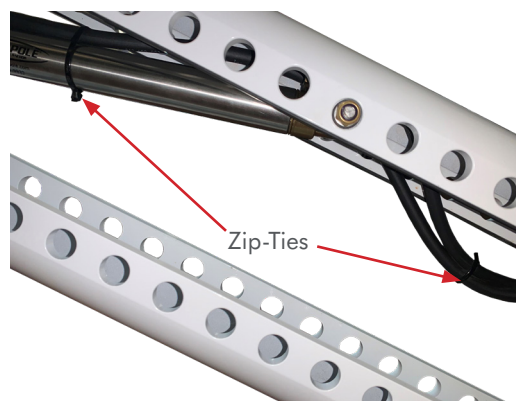

Figure 8

Need help? Contact our Customer Service Team at **1 + 813.689.9932 Option 2**

SPORTSMAN II UPPER U-CHANNEL REPLACEMENT INSTRUCTIONS

- All models 2017 & Later

