



SWIFT. SILENT. SECURE.

# SPORTSMAN II UPPER U-CHANNEL REPLACEMENT INSTRUCTIONS

- All Models 2012-2016

## Installation Tools:

- 9/16" Wrench
- 9/16" Socket
- 5/8" wrench
- 1/2" Wrench
- 1/2" Socket
- Ratchet
- Spreader Block (Not Included)
- 1/4" Flat Punch
- Zip Ties (x2)
- Masking Tape

**NOTICE:** No mounting hardware is included in this kit.

**IMPORTANT!** Replace any hardware item that is worn or damaged. Always replace nylon lock nuts with new. To order a new **Hardware Kit**, scan **QR CODE A**.



DO NOT touch the spike with bare hands.

## PRESSURE RELIEF:

**STEP 1** Lower the Power-Pole Anchor® down so the Everflex™ spike is about a foot off the ground.

**STEP 2** Manually push the anchor into closed position, relieving pressure. Manually lower the anchor back to the ground.

## REMOVAL:

**STEP 1** Remove the Hardware that attaches the **Upper Cylinder Fitting** to the U-Channel using a 1/2" Socket and wrench. **FIG 1**

**STEP 2** Cut the two zip ties that secure the hydraulic tubing.

**STEP 3** Unscrew both **Compression Fitting Nuts** with a 9/16" wrench. **FIG 2**

**IMPORTANT!** Cover tubing ends with masking tape to prevent contaminants from entering.

**STEP 4** Remove the **Black and Blue Tubing** from the Power-Pole Anchor by pulling them through the U-Channel.

**STEP 5** Follow diagrams (see page 3) to remove all hardware that attaches the defective U-Channel.



QR Code A

Hardware Kit

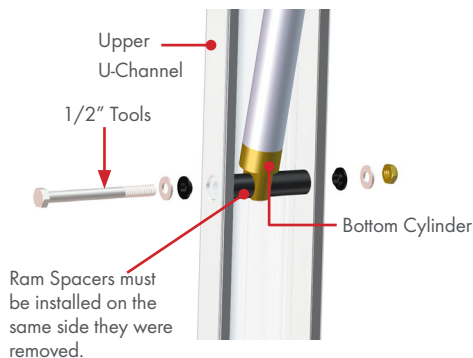

Figure 1

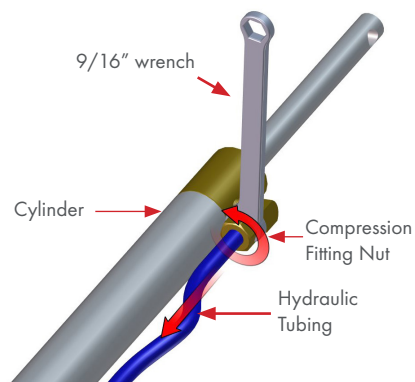

Figure 2

Need help? Contact our Customer Service Team at **1 + 813.689.9932 Option 2**

# SPORTSMAN II UPPER U-CHANNEL REPLACEMENT INSTRUCTIONS

- All Models 2012-2016

## INSTALLATION:

**STEP 1** Follow the diagrams on page 3 to install the new U-Channel at the **Knuckle** and **Stern Bracket**.

**STEP 2** Route the Hydraulic Tubing through the new U-Channel.

**STEP 3** Insert the **BLUE Hydraulic Tubing** and **Ferrule** into the **Compression Fitting** on the lower U-Channel. With the **Tubing** fully inserted, thread on the **Compression Fitting Nut**. Repeat this procedure with the **BLACK Tubing** and the other **Compression Fitting**. **FIG 3**

**STEP 4** Tighten both **Compression Fitting Nuts** with a **9/16" Wrench**. **FIG 4**



The **Nuts** must be tightened down far enough so **NONE** of the **Compression Fittings' Threads** are visible or hydraulic failure may occur. **FIG 4**

**STEP 5** Follow the diagrams on page 3 to install the hardware that mounts the **Cylinder** to the **U-Channel**.

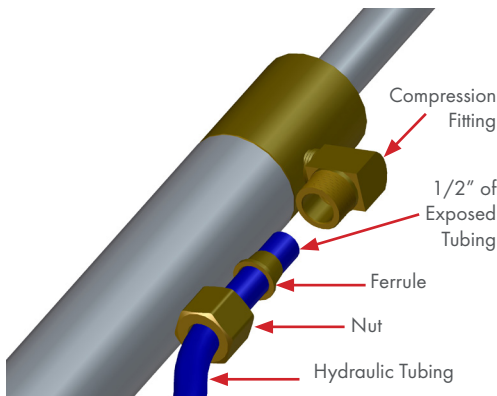

**Figure 2**

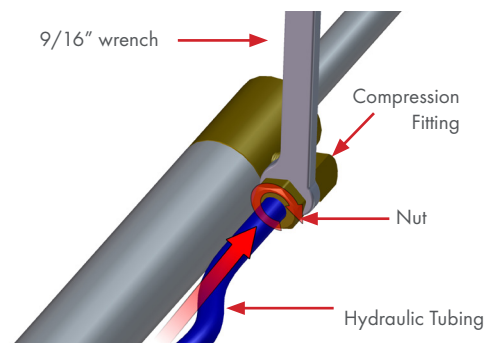

**Figure 3**

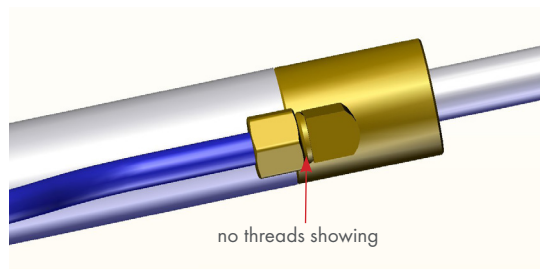

**Figure 4**

# SIGNATURE SERIES II UPPER U-CHANNEL REPLACEMENT INSTRUCTIONS

- All Models 2012-2016

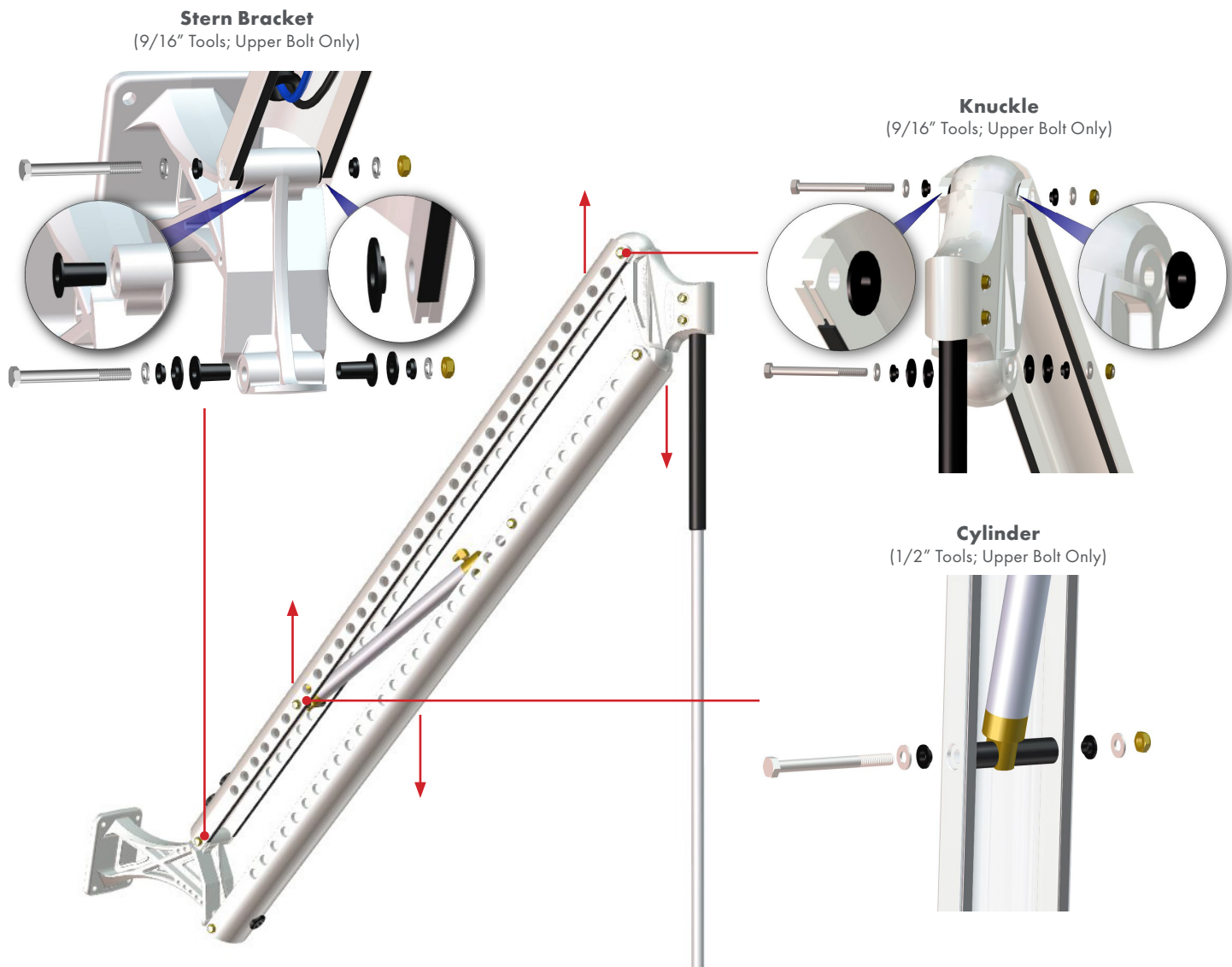

Need help? Contact our Customer Service Team at **1 + 813.689.9932 Option 2**