



SWIFT. SILENT. SECURE.

PRO II LOWER U-CHANNEL REPLACEMENT INSTRUCTIONS

- All Models 2012-2016

Installation Tools:

- 9/16" Wrench
- 9/16" Socket
- 1/2" Wrench
- 1/2" Socket
- Ratchet
- Spreader Block (Not Included)
- 1/4" Flat Punch

NOTICE: No mounting hardware is included in this kit.



DO NOT touch the spike with bare hands.

REMOVAL & INSTALLATION:

STEP 1 Lower the Power-Pole Anchor[®] down so the Everflex[™] spike is about a foot off the ground.

STEP 2 Follow diagrams (see reverse) to remove all hardware that attaches the lower U-Channel.

STEP 3 Install the new U-channel by following the diagrams (see reverse).

IMPORTANT! Replace any hardware item that is worn or damaged. Always replace nylon lock nuts with new. To order a new **Hardware Kit**, scan **QR CODE A**.



QR Code A

Hardware Kit

Need help? Contact our Customer Service Team at **1 + 813.689.9932 Option 2**

PRO II LOWER U-CHEMEL REPLACEMENT INSTRUCTIONS

- All Models 2012-2016

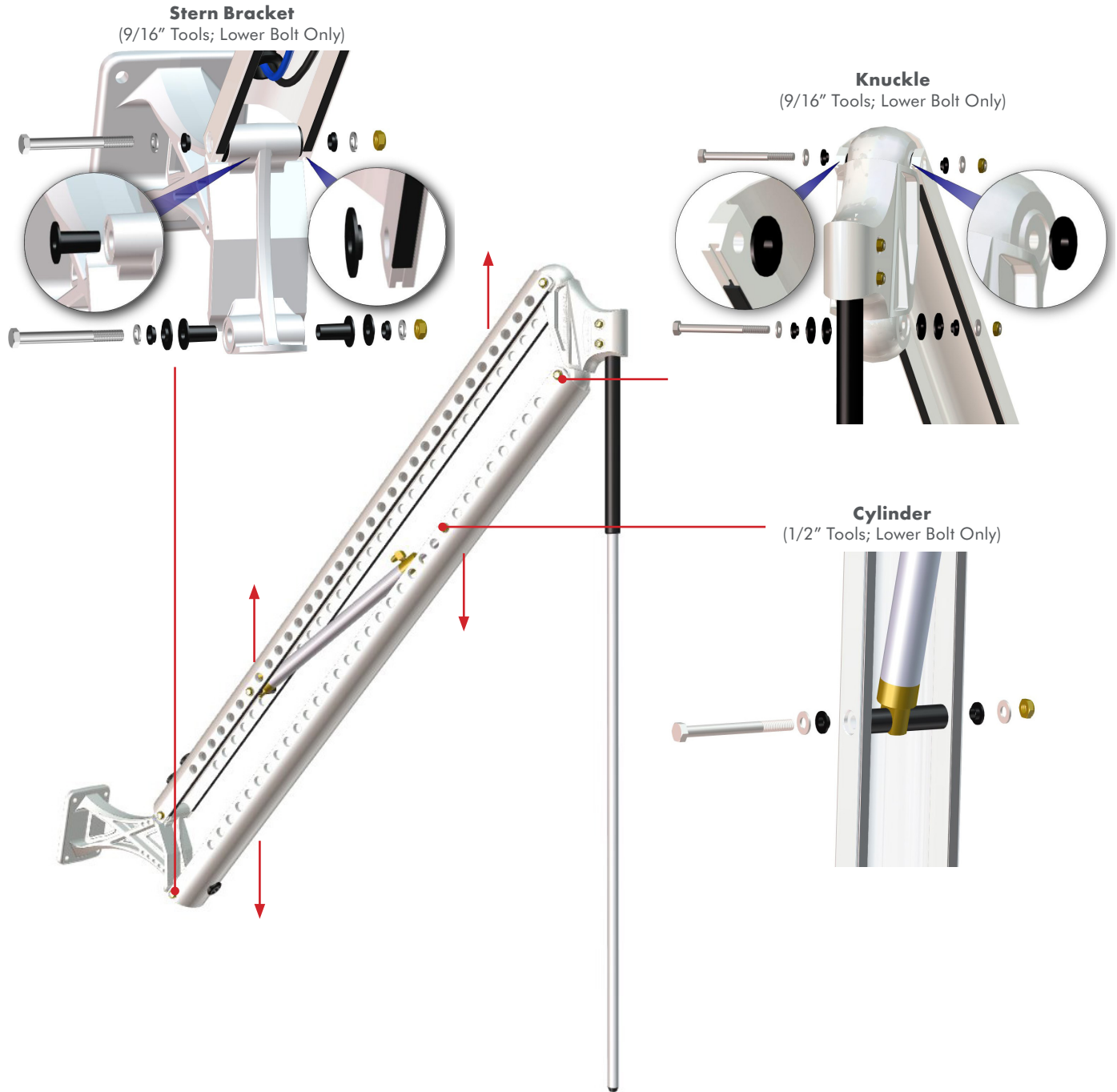

Need help? Contact our Customer Service Team at **1 + 813.689.9932 Option 2**