



SWIFT. SILENT. SECURE.

BLADE STERN BRACKET REPLACEMENT INSTRUCTIONS

- Instructions for Solid Aluminum Stern Brackets with Hydraulic Tubing
- 8' Models 2012-2016
- 10' Models 2012-2016

IMPORTANT! Replace any hardware that is worn or damaged. Always replace nylon lock nuts. To order proper hardware, scan QR Code A.

PRESSURE RELIEF:

STEP 1 Lower the Power-Pole Anchor® down so the Everflex™ spike is about a foot off the ground.

STEP 2 Manually push the anchor into closed position, relieving pressure. Manually lower the anchor back to the ground.



DO NOT touch the spike with bare hands.

REMOVAL:

STEP 1 Cut the zip tie securing the **BLUE Hydraulic Tubing** to the **Cylinder** and use a **9/16"** wrench to unscrew the **Compression Fitting Nut**. **FIG 1**

STEP 2 Remove the **Compression Fitting Nut** from the **Hydraulic Tubing** by cutting the Tubing squarely just behind the **Ferrule** with a razor blade. **FIG 2**



Cover hose ends with masking tape to ensure contaminants do not enter the system.

Installation Tools:

- 9/16" Wrench
- 9/16" Socket
- Ratchet
- Spreader Block
- Protective Gloves
- Masking Tape
- Pliers
- Marine-Grade Sealant
- Scissors
- Zip-Ties
- Razor Blade



QR Code A
Stern Bracket Hardware

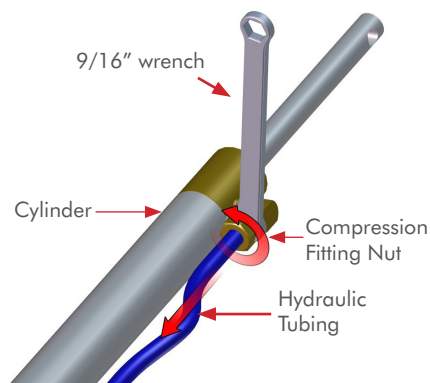

Figure 1

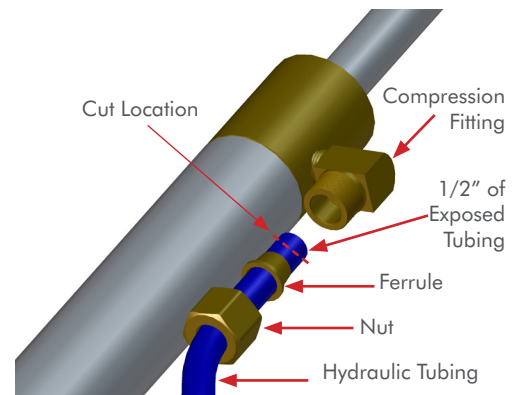

Figure 2

Need help? Contact our Customer Service Team at **1 + 813.689.9932 Option 2**



SWIFT. SILENT. SECURE.

BLADE STERN BRACKET REPLACEMENT INSTRUCTIONS

- Instructions for Solid Aluminum Stern Brackets with Hydraulic Tubing
- 8' Models 2012-2016
- 10' Models 2012-2016

REMOVAL (Continued):

STEP 3 Remove the **Bottom Bolt** of the **Hydraulic Cylinder** with a 1/2" Socket & Wrench to gain access to the **Lower Compression Fitting Nut**. **FIG 3**

STEP 4 Repeat **STEPS 1 & 2** for the **BLACK Hydraulic Tubing**.

STEP 5 Remove the **Stern Bracket Bolts** with and Mounting Hardware with a 9/16" Socket & Wrench. **FIG 4**

NOTICE: Safely store all mounting hardware, it will be reused when installing the new Stern Bracket.

STEP 6 Insert and twist the spreader block to remove the **Top & Bottom U-Channels** from the **Stern Bracket**. **FIG 5**

STEP 7 Remove the Four **Mounting Bolts** using a 9/16" Socket & Wrench **FIG 6**

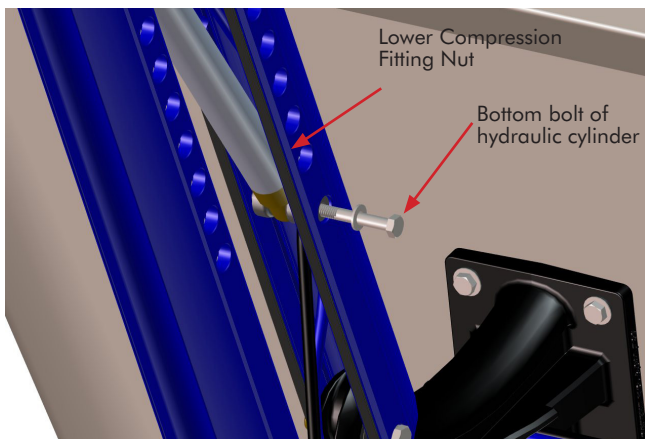

Figure 3

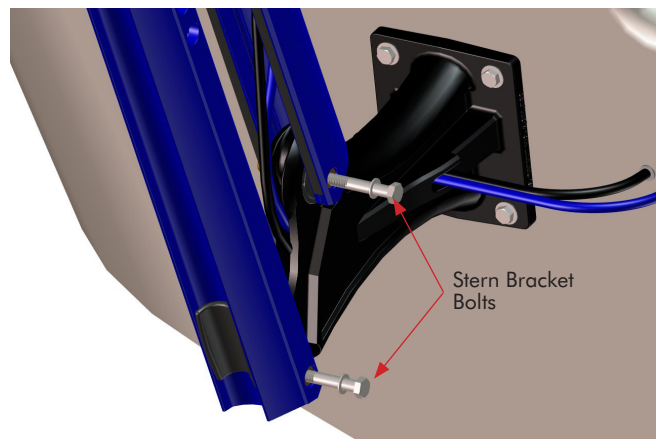

Figure 4

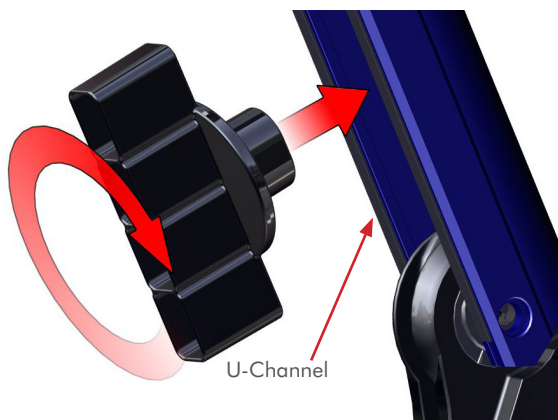

Figure 5

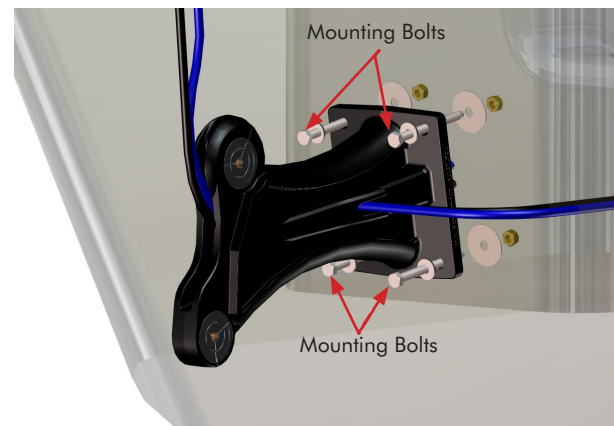

Figure 6

Need help? Contact our Customer Service Team at **1 + 813.689.9932 Option 2**



SWIFT. SILENT. SECURE.

BLADE STERN BRACKET REPLACEMENT INSTRUCTIONS

- Instructions for Solid Aluminum Stern Brackets with Hydraulic Tubing
- 8' Models 2012-2016
- 10' Models 2012-2016

INSTALLATION:

STEP 1 Install the new **Stern Bracket (H)** and the **Upper & Lower U-Channels** in reverse order of removal. For transom installations, apply a small amount of Marine Grade Sealant around each Mounting Bolt Hole. **FIG 6 & 7**

STEP 2 Route the **Hydraulic Tubing** through the **Stern Bracket (H)** as shown in **FIG 6**.

STEP 3 With both the **BLUE** and **BLACK Hydraulic Tubing** in line with their respective **Hydraulic Fittings**, feed them through a **Compression Fitting Nut** and **Ferrule**. **FIG 8**

IMPORTANT! The Tubing needs to pass through the ferrule far enough to expose approximately half an inch of Tubing. **FIG 8**

IMPORTANT! Be sure to allow an adequate amount of slack in the Hydraulic Hoses between the Stern Bracket and the point where the hoses enter the vessel. This will provide for full up and down operation.

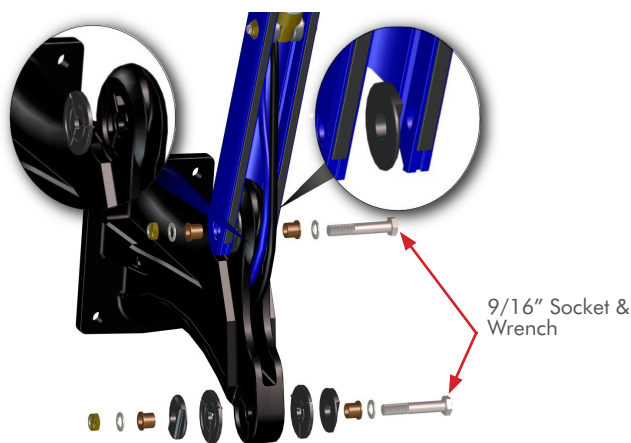

Figure 7

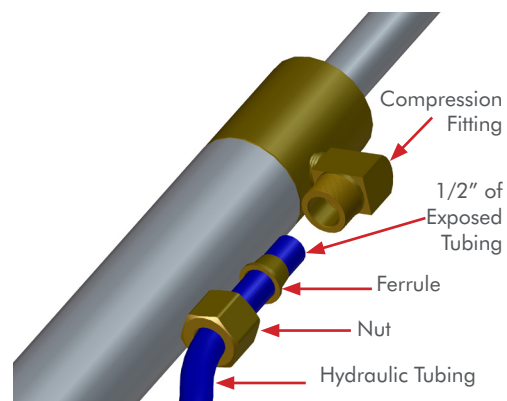

Figure 8



SWIFT. SILENT. SECURE.

BLADE STERN BRACKET REPLACEMENT INSTRUCTIONS

- Instructions for Solid Aluminum Stern Brackets with Hydraulic Tubing
- 8' Models 2012-2016
- 10' Models 2012-2016

INSTALLATION (Continued):

STEP 4 Insert the **BLUE Hydraulic Tubing** into its respective **Compression Fitting**. With the **Tubing** fully inserted, thread on the **Compression Fitting Nut**. Repeat this procedure with the **BLACK Tubing**.

STEP 5 Tighten both **Compression Fitting Nuts** with a **9/16" wrench**. **FIG 9**



The nuts must be tightened down so that **NONE** of the compression Fitting's Threads are visible or hydraulic failure may occur. **FIG 10**

STEP 6 Once the **Hydraulic Tubing** is securely fastened to the **Cylinder Fittings**, place the bottom of the **Cylinder** back into its previous position and install the bolt and hardware. Tighten lock nut snug using a **1/2" socket & wrench**. **FIG 11**

STEP 7 Secure **BLUE Hydraulic Tubing** to the top of the **Cylinder** by using Zip Ties.

STEP 8 Run the Power-Pole Anchor through several full up and down cycles to purge any air that may have accumulated in the hydraulic system.

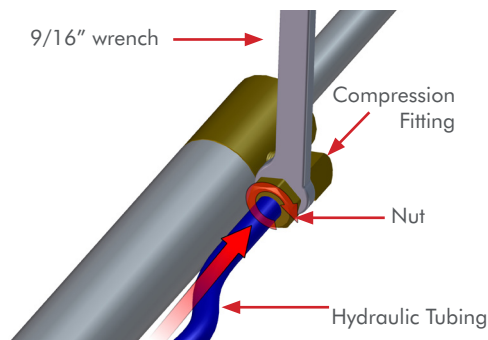

Figure 9

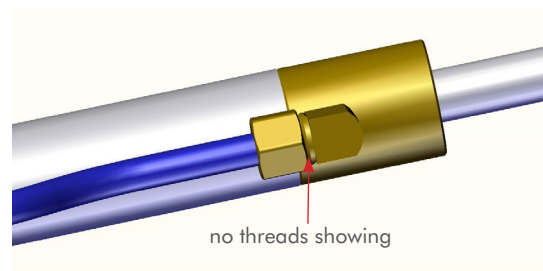

Figure 10

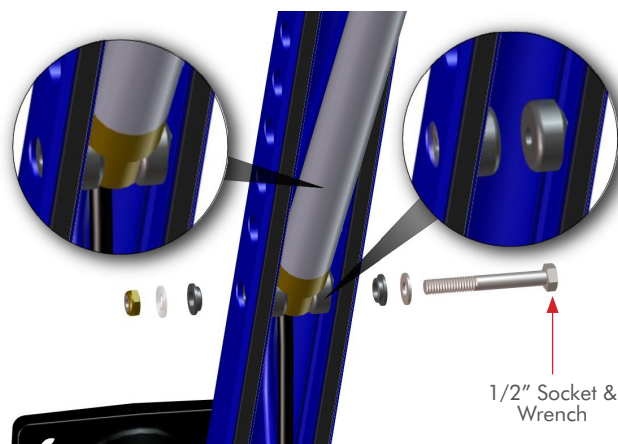

Figure 11