



SWIFT. SILENT. SECURE.

# U-Channel Replacement INSTRUCTIONS

- 10' Models 2017 & Later
- 8' Models 2019 & Later

## Installation Tools:

- 1/2" & 9/16" Wrenches
- 1/2" & 9/16" Sockets
- Phillips Screwdriver
- Ratchet
- Vise Grips
- Rubber Mallet
- 1/4" Punch
- Marine-Grade Sealant
- Impact Wrench

## Hardware (Included):

- A.** (5) 5/16" Lock Nuts
- B.** (4) 3/8" Jam Nuts
- C.** (1) U-Channel (Upper or Lower)  
(Includes U-Channel Bolt)

**NOTE:** The diagrams in these instructions illustrate a lower U-Channel replacement. If replacing upper U-Channel, follow the same procedures with the upper U-Channel & hardware.

## REMOVAL:

**STEP 1:** Lower the Power-Pole Anchor so the Spike is touching the ground.

**STEP 2:** Remove the (8) **Phillips-Head Screws** that hold the (2) **Shrouds** to the Stern Bracket Assembly using a Phillips Screw Driver. Then, remove **Shrouds**. **FIG 1**

**STEP 3:** Hold one of the bottom **Jam Nuts** with a 9/16" Wrench and place the Impact Wrench on the other. Then, loosen and remove **Jam Nut** with the Impact Wrench. Only one **Jam Nut** will come free. **FIG 2**

**STEP 4:** On the side where the **Jam Nut** came free, hold threads with Vise Grips. Then Remove other **Jam Nut** with Impact Wrench. **FIG 2**

**NOTE:** If second **Jam Nut** will not come off, drive pin out using a Rubber Mallet and 1/4" punch or 5/16" Bolt.

**STEP 5:** Remove **one** of the (2) **Jam Nuts** on the other U-Channel by following the same procedure in **Step 3**.

**STEP 6:** Remove the (5) **Lock Nuts** from the **Sheet Metal** using a 1/2" Socket and Wrench. **FIG 3**

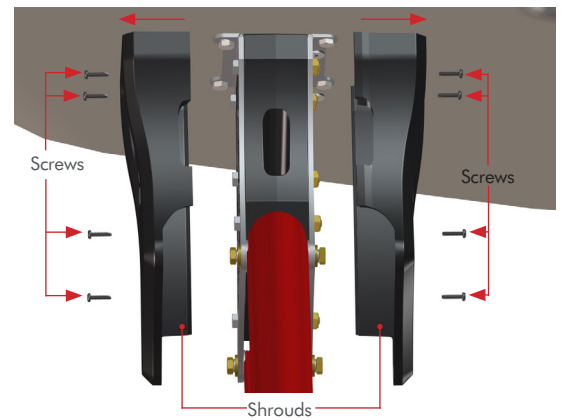
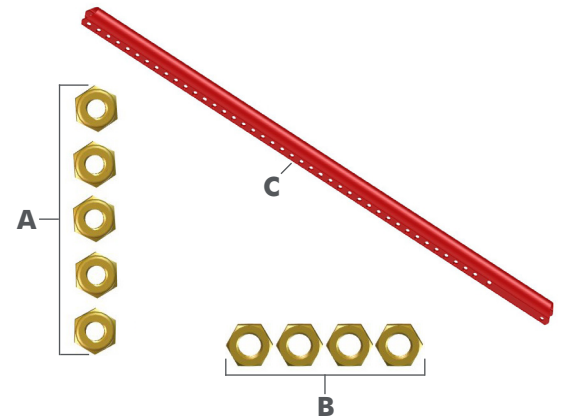
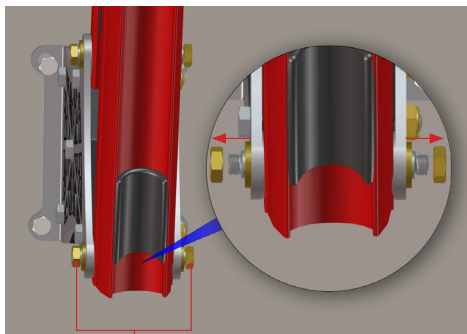
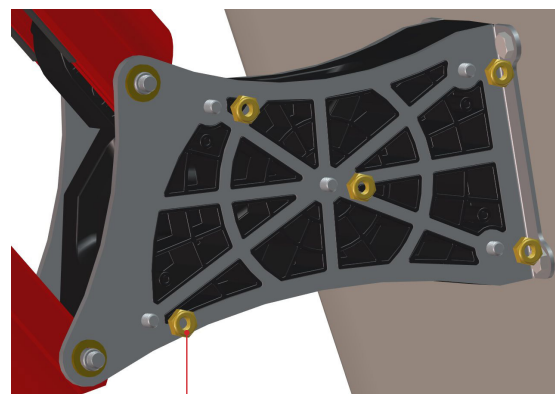

Figure 1



Jam Nuts  
9/16" Tools

Figure 2



Lock Nuts  
1/2" Wrench

Figure 3

Need help? Contact our Customer Service Team at **1 + 813.689.9932 Option 2**

# U-Channel Replacement INSTRUCTIONS

- 10' Models 2017 & Later
- 8' Models 2019 & Later

## REMOVAL (Continued):

**STEP 7:** Follow diagrams below to remove all the remaining hardware that attaches the U-Channel to the Power-Pole Anchor. You may need to use the spreader block to release the U-Channel from the top knuckle joint.

**IMPORTANT:** Remove only top bolts for upper U-Channel replacements and bottom bolts for lower.

**NOTE:** Hydraulic Hoses DO NOT need to be disconnected.

### Stabilizer Bar

(10' Models ONLY; 9/16" Tools; Upper or Lower Replacement)

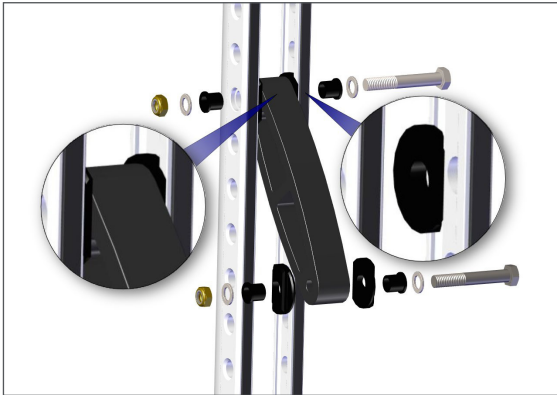

### Knuckle Removal

(9/16" Tools; Upper or Lower Replacement)

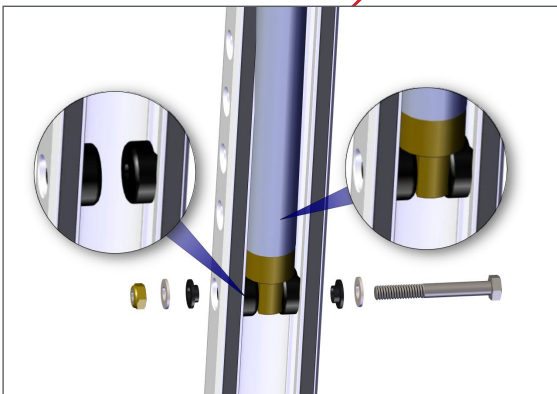
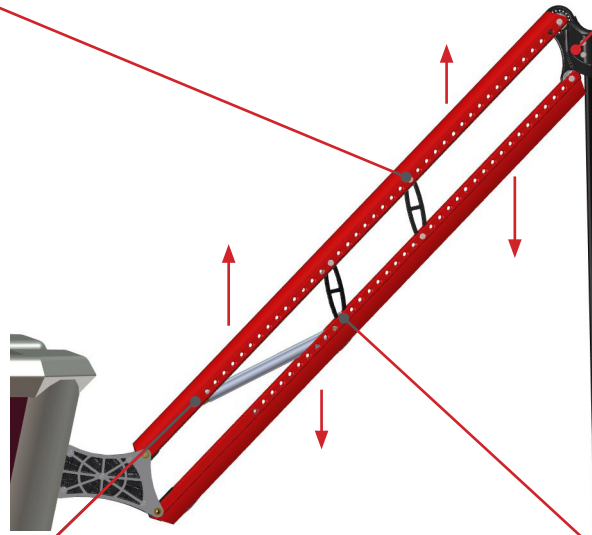
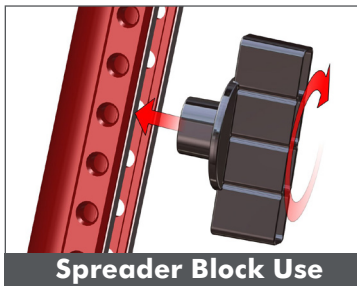
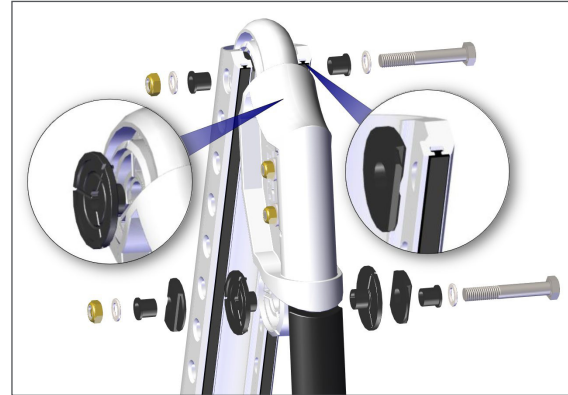

### Cylinder End Cap

(1/2" Tools; Upper Replacement ONLY)

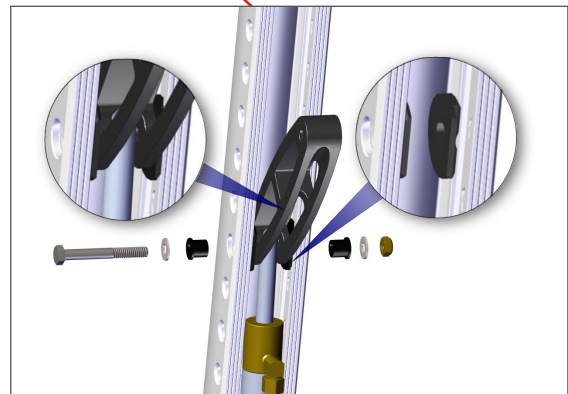

### Cylinder With Stabilizer Bar

(1/2" Tools; Lower Replacement ONLY)

Need help? Contact our Customer Service Team at **1 + 813.689.9932 Option 2**

# U-Channel Replacement INSTRUCTIONS

- 10' Models 2017 & Later
- 8' Models 2019 & Later

## REMOVAL (Continued):

**STEP 8:** Drive the (5) **Stern Bracket Bolts** flush with **Sheet Metal**. **FIG 4**

**STEP 9:** Remove the (2) **Transom/ Adapter Plate Bolts** on the starboard side of the Stern Bracket Using a 9/16" Socket and Wrench. **FIG 4**

## INSTALLATION:

**STEP 1:** Follow the picture that matches your scenario to install the new **U-Channel (C)**. Be sure to install **Plastic Washers** between **U-Channel** and **Sheet Metal**. **FIG 1** or **FIG 2**

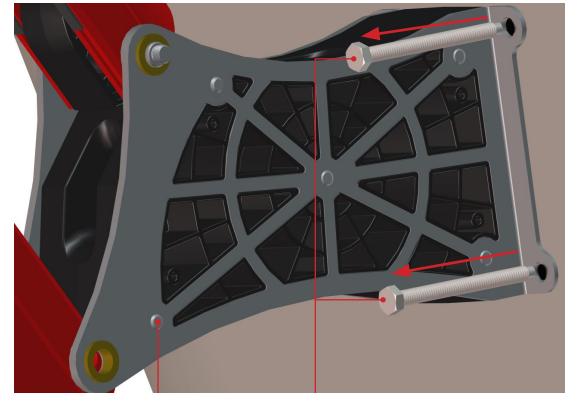

Stern Bracket Bolts Transom/Adapter Plate Bolts **Figure 4**

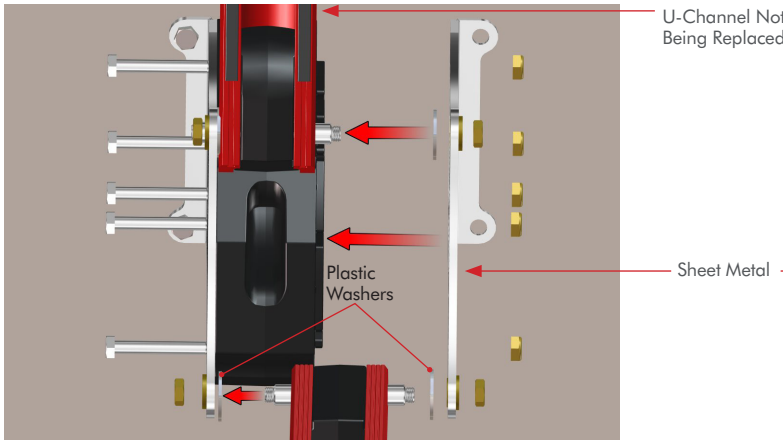

**Figure 1**

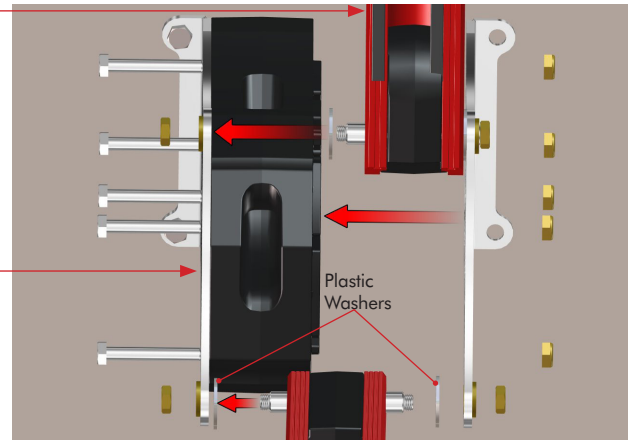

**Figure 2**

**STEP 2:** Reinstall **Transom/Adapter Plate Bolts** using a 9/16" Socket and Wrench. **FIG 3**

**IMPORTANT:** For transom installs, apply a liberal amount of **Marine-Grade Sealant** between the **Sheet Metal** and **Hull** as well as around **Transom Bolt Holes**.

**STEP 3:** Drive the **Stern Bracket Bolts** back through the **Stern Bracket** and install (5) **NEW 5/16" Lock Nuts (A)** using a 1/2" Socket and Wrench (Do not use impact wrench). **FIG 3**

**STEP 4:** Install **NEW Jam Nuts (B)** onto **U-Channel Bolts** using a 9/16" Socket Wrench. **FIG 3**

**NOTE:** If **Sheet Metal Bearings** are not flush with **Sheet Metal**, place a 9/16" Socket over **Jam Nuts** and tap them with a rubber mallet.

**STEP 5:** Install Left and Right **Shrouds**. Tighten the (8) **Screws** with a Phillips Screwdriver. Be careful not to over-tighten.

**STEP 6:** Connect new **U-Channel** to all components. Follow Diagrams on **Page 2**. Tighten all lock nuts flush with ends of bolts.

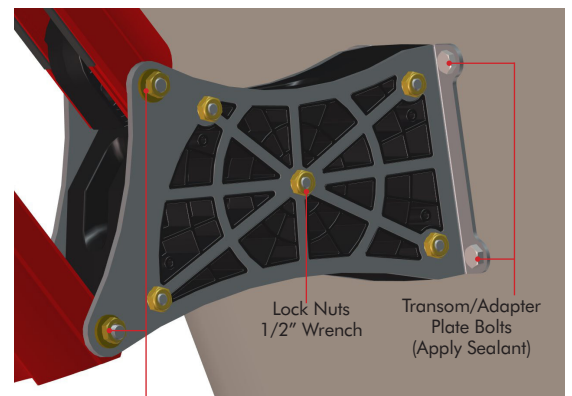

Jam Nuts/Sheet Metal Bearings (9/16" Wrench)

**Figure 3**

Need help? Contact our Customer Service Team at **1 + 813.689.9932 Option 2**