



SWIFT. SILENT. SECURE.

## BOLT SET FOR BLADE KNUCKLE (Upper or Lower) INSTRUCTIONS

### Hardware (Included):

- A** (2) 3/8" x 2-1/2" Bolts
- B** (4) 3/8" Washers
- C** (4) 3/8" Bushings (Outer)
- D** (4) 3/8" Bushings (Middle)
- E** (4) 3/8" Bushings (Inner Knuckle Joint)
- F** (2) 3/8" Nylon Lock Nuts

### Installation Tools:

- 9/16" Wrench
- 9/16" Socket
- Ratchet
- Spreader Block (Included)

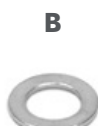

### INSTALLATION DIAGRAM

**WARNING:** Do not touch spike with bare hands.

**IMPORTANT:** Lower Power-Pole Anchor down so that the spike is touching the ground.

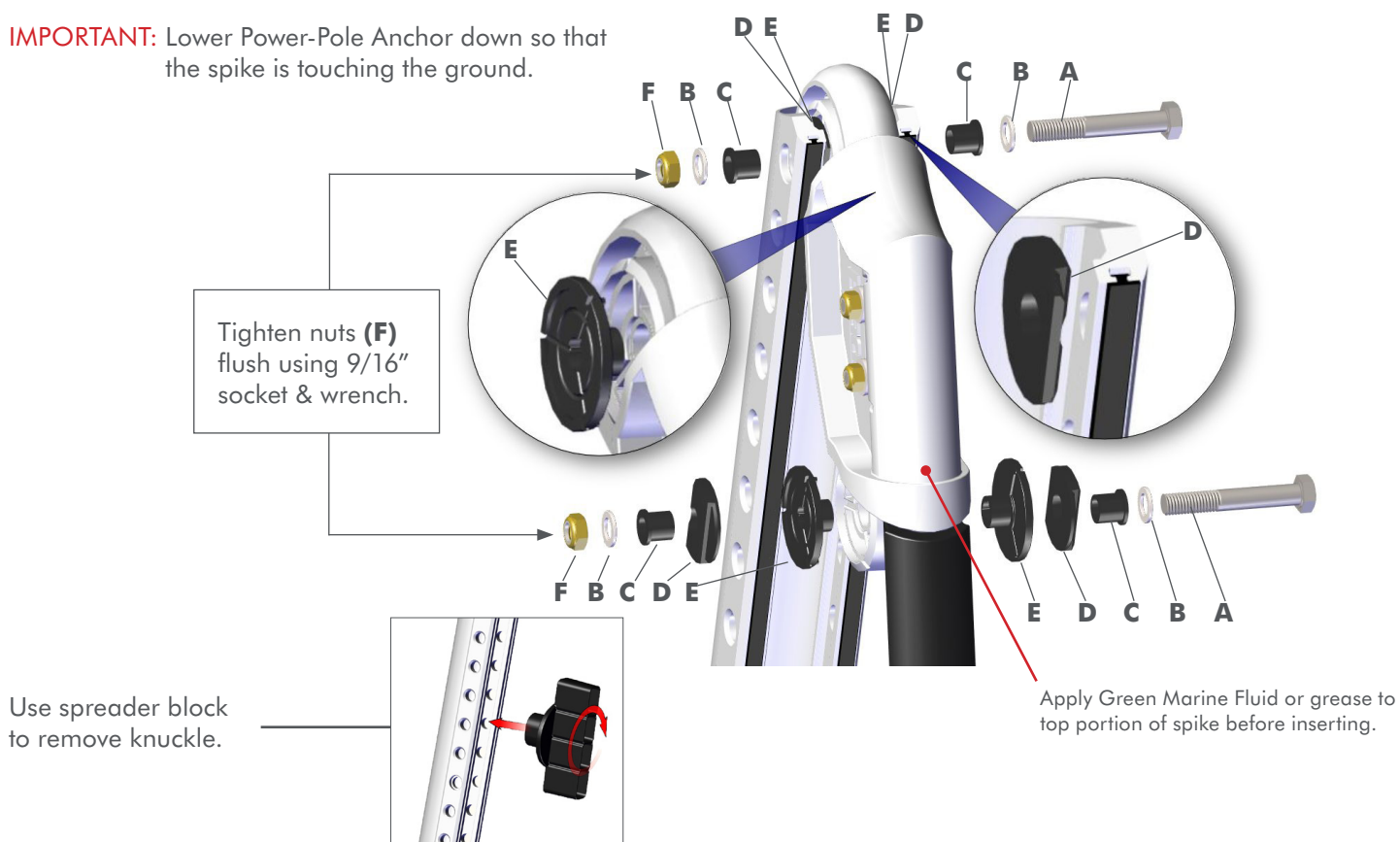

Need help? Contact our Technical Support Team at **1 + 813.689.9932 Option 2**